

TECHNICAL DATA SHEET

SECUMAX 148  
NO. 148001

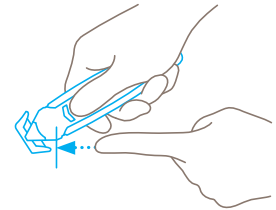

Safety technology



**Concealed blade – a maximum degree of safety**

The SECUMAX 148 blade is not an open one, but is hidden from people and goods. This provides you with a maximum degree of safety from cut injuries and from damage to goods.



DISPOSABLE SAFETY KNIFE WITH CONCEALED BLADE AND ROBUST BLADE HEAD.

Order No. 148001.12

**Feeling good – in every aspect.**

Safety knives that are both disposable and sustainable? Of course! The SECUMAX 148 is made with more than 80% recycled plastic. The glass fibre reinforcement and the robust, 2-cutting edge blade head ensure longer service lives. This makes SECUMAX 148 ideal for tougher cutting tasks. The ergonomic handle and lightweight design will also aid safe and efficient working.

**Robust blade head**

The plastic-covered blade head is particularly robust with a blade thickness of 0.5 mm. This SECUMAX 148 can therefore take on especially difficult cutting materials in logistics and production.

**Concealed blade**

The blade head's two cutting edges are safely concealed to protect users and goods and are yet capable of safely cutting 2-ply cardboard boxes and much more.

**Clever guide surfaces**

Another reason why the SECUMAX 148 can cut through cardboard so easily? The guide surfaces located right at the front of the safety knife help you to cut at an angle. Angled cutting means less material resistance!

**Ergonomically shaped**

Right handed? Left handed? It's really all the same. The SECUMAX 148 fits perfectly in any hand. Gently arched outer edges, coupled with light ribbing and a low weight, ensure an ergonomic experience.

**Sustainably built**

MARTOR prioritises sustainability. SECUMAX 148 is the first MARTOR disposable knife to use only glass fibre reinforced recycled plastic. Its low weight also means materials have been used sparingly.

## USAGE

---

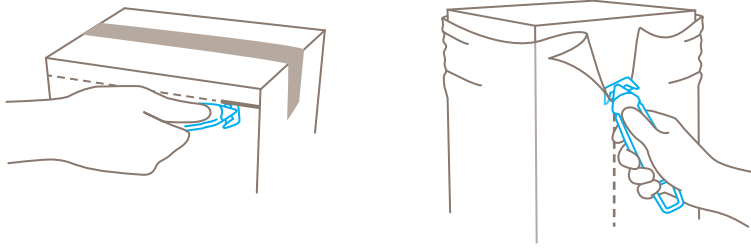

## PRODUCT FEATURES

---

### Technical features



Maximum safety



Disposable knife



Abrasion resistant



Very ergonomic



2-cutting edge blade



Cutting depth



For right and left handers



Lanyard hole



Printable for promotional purposes

### Main cutting materials



Cardboard: up to 2-ply



Wrapping, stretch and shrink foil



Plastic strapping band



Bagged goods



Layers of foil or paper



Yarn, cord



Felt



Rubber



Tape

### Installed blade

Blade thickness 0.50 mm.

## BLADE CHANGE

---

The blade is moulded into the body of the knife and cannot be changed.

Blade thickness 0.50 mm.

## SERVICES OFFERED



Safety poster



Technical data sheet



Consulting service

## PRODUCT AND PACKAGING DETAILS

Order No.	NO. 148001.12	Packaging unit	10 in box (loose)
Knife size (L x W x H)	142.4 x 11 x 38.7 mm	Size outer pack	85 x 42 x 150 mm
Weight knife	26.0 g	Weight outer pack	277.0 g
Basic material	Recycled plastic, glass fibre reinforced	EAN Code outer pack	4002632803796
Cutting depth	6.2 mm	Customs tariff number	82119200

## SAFETY CERTIFICATE

Date of issue	07.03.2023
Certification	GS certificate NO. 185848-7711-55094-2023

### Certificates and awards



## SAFETY ADVICE

To ensure that you use your new MARTOR knife safely and most effectively, please read and note the following user instructions. Please keep the written guide in a safe place so that you can access it at any time.

**1. Usage advice:** Please use the product carefully for described work only and not for any purposes other than those that are intended. Please take the correct handling and the proper use of the cutting tool into account in this regard.

**2. Special application Instructions to avoid the danger of injuries:** Only use cutting tools that are in perfect condition and have sharp, clean and undamaged blades. Employ the utmost care when handling the knives. CAUTION: The blade is sharp and can result in serious and deep cuts. Therefore, never reach into the blade! To reduce the danger of injuries, hold the hand that is being used to restrain and stabilise the

cutting base in such a manner that the restraining hand or even other body parts are not endangered in the event that the knife slips. Do not modify this product in any way. Modifications of any kind may impair product safety. CAUTION: The risk of injury caused by manipulation of this product is extremely high. When both cutting edges are no longer sharp, dispose of the knife as general waste.

**3. Non-use of the knife:** Store the knife in a secure place.

**4. Care instructions:** Always keep the knife clean and do not expose it to unnecessary humidity to safeguard a long service life.

**CAUTION: No liability will be assumed for consequential losses. Subject to technical changes and errors! This knife does not belong in the hands of children!**

## ACCESSORIES

---

### BELT HOLSTER S

NO. 9920



What do you do with your cutting tools when you are not actually using them? The MARTOR BELT HOLSTER S is a robust holder that allows you to carry all compact MARTOR knives as well as our safety scissors at all times. In addition, the compartments are designed to allow you to load different tools: for example you can also carry a pen or a pack of blades. The MARTOR BELT HOLSTER is the ideal place to stow your tools safely when moving from A to B - and have them at hand, as soon as they are required.

---

### BELT HOLSTER XXL

NO. 9924



The BELT HOLSTER XXL is a real space miracle. With it, you not only transport your MARTOR cutting tools safely from A to B. All other work utensils are always within reach. The BELT HOLSTER XXL has two large compartments: the inner one is lockable, the outer one is equipped with a knife safety device. You are also well equipped when it comes to carrying options. Choose flexibly between strap, Velcro fastener and clip.

---

### TOOL RETRACTOR

NO. 9960



The TOOL RETRACTOR protects your cutting tool from loss and from falling down. Its core is the heavy-duty Kevlar cord that can be extended up to 90 cm. As soon as you let go of your knife, it is returned to you via the flexible cord. Your hands are free for other activities – the knife always remains at hand. The carabiner is designed for your belt loop, the steel cord at the other end fits through the eyelet of your cutting tool.

---

### CONNECTOR

NO. 9946



Materials that require cutting can sometimes be too high or too far away. The CONNECTOR from MARTOR helps you to overcome distances when cutting. The CONNECTOR is simple to attach to our SECUMAX 350, 350 SE, 150 and 148 safety knives and makes a stable connection. At the other end, the CONNECTOR can be connected, for example, to the MARTOR TELESCOPIC POLE. You then gain much more reach.

---

### CONNECTOR SET

NO. 9947



Materials that require cutting can sometimes be too high or too far away. The CONNECTOR SET from MARTOR helps you to overcome distances when cutting. It includes the CONNECTOR which can be simply connected to our SECUMAX 350, 350 SE, 150 and 148 safety knives, and the matching MARTOR TELESCOPIC POLE. This set gives you extra reach of up to 95 cm.

---

## MANUFACTURER

---

MARTOR KG | Lindgesfeld 28 | 42653 Solingen | Germany  
T +49 212 73870-0 | info@martor.de | www.martor.com